



Aeron[®] Window Control System

Easy opening. With Aeron[®], you can effortlessly open those hard-to-reach windows, allowing fresh natural air to flow in.

Contents



Aeron® Smart
Window Actuator

Page 3



Aeron® System
Wireless Remote

Page 7



Yale Connect
Plus Hub 2

Page 9



Aeron® Wireless
ZigBee Module

Page 11



Aeron® Rain Sensor

Page 13



Aeron® Rain
Sensor Adaptor

Page 15



Aeron® Accessories
and Spare parts

Page 17

Aeron® Window Control System



The Yale Aeron® Smart Window Control System gives you complete control of your windows, wherever you are. Open and close them at the touch of a button, whether using a wall switch, the Aeron® Wireless Remote, or from anywhere in the world via the Yale Home App.

Perfect for hard-to-reach or heavy windows, Aeron® offers seamless, remote-controlled operation and can manage up to 30 windows from a single hub. Open and close them individually or in groups through the Yale Home App or Aeron® Remote for effortless flexibility.

Installation is simple, no complex wiring required. Just power each unit, and the advanced Zigbee mesh network takes care of the rest. You can also customise window opening with four preset opening positions (100mm, 150mm, 200mm, 250mm) and a 75mm 'vent' position, allowing natural ventilation and improving energy efficiency.

Designed with safety in mind, Aeron® supports compliance with the **Building Code of Australia – Prevention of Falls from Windows** when set to a 100mm opening and used with approved window systems. It also integrates effortlessly with **third-party building management and fire systems** using a hardwired setup, ensuring compatibility with broader smart home ecosystems.

Being part of the Yale Home App means you can connect Aeron® with other Yale Home devices, such as smart locks, for ultimate home control. Instantly close all windows when locking up for the night or leaving the house—giving you peace of mind at the push of a button.

With the flexibility to expand your system over time, Aeron® grows with your home, delivering smart, secure, and effortless window control—rain or shine.

Note: Aeron® wiring must be completed by a licensed electrician. Please ensure that all wiring is completed by a professional to be compliant as governed by local building codes, regulations, and/or laws.

Application

- Awning and casement windows
- High, out of reach windows
- Conveniently open single or a group of windows
- Commercial buildings
- Residential buildings

Note: Indoor use only. Aeron® Actuator must be used on hard-to-reach windows.

Aeron® Window Control System

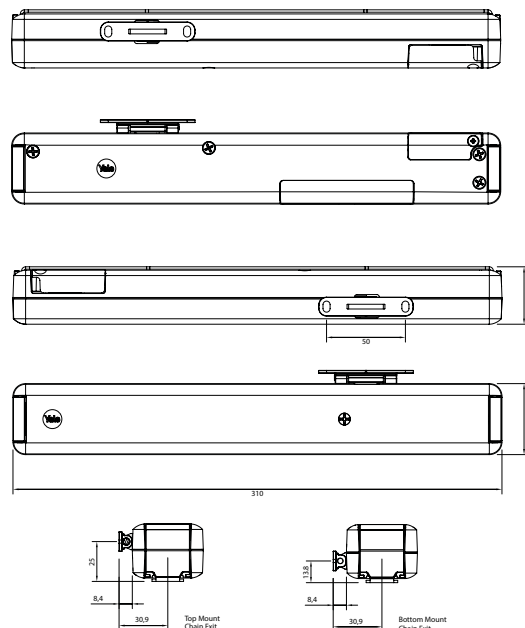
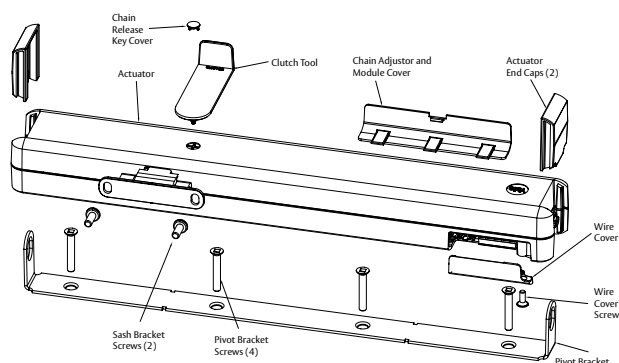

Benefits

- Provides automated operation of awning or casement windows that are too high or too large to be manually operated
- Unit can be top or bottom mounted with no additional parts required
- Provides natural ventilation: heating or cooling (depending on the climate)
- Smart Home technology gives capability for smart automation of window operations
- Contributes to an energy efficient home
- Operated via wall switch, wireless remote or Yale Home App
- Automatically close windows when it rains with the additional Rain Sensor
- No complicated network wiring required
- Over The Air (OTA) updates for the smart accessories
- Retrofittable to Conel and Elevation Actuators



Technical Specifications

| | |
|------------------------------------|---|
| Chain Limiting | Limit chain between 100-250mm at 50mm increments |
| Maximum Peak Load | 600mA |
| Maximum Chain Opening | 275mm |
| Dimensions | 310L x 45W x 36H (dimensions are in mm) |
| Endurance | 12,000 Cycles |
| Operating Temperature | 0° to 50°C |
| Opening/Closing Time (full stroke) | Approx 30 sec |
| Finishes | Black (BLK), White (WH), Special Powdercoat (SPEC) |
| Humidity | 0 to 95% |
| Materials | Actuator body: Cast zinc Sash bracket: Cast 304SS Chain: Stainless steel 304 Pivot bracket: Pressed Stainless steel 304 |
| Operating Force Open/Close | 90N |
| Negative Holding Force | 3000N |
| NSS Testing on chain | 1000 Hours |
| Noise Level | 55dB @ Maximum window Load |
| Compliance | <ul style="list-style-type: none"> • Regulatory Compliance Mark (RCM) for AU & NZ • IP30 Rated (if installed according to installation instructions) • FCC Part 15b Compliance (Actuator with Zigbee module) • FCC Part 15C Compliance (Zigbee module FCC ID: 2A9SQ-SWAAZMD) • ICES-003:2020 ISSUE 7 (Actuator with Zigbee module) • Industry Canada (Zigbee module IC ID: 29955-SWAAZMD) |
| Australian Standard | <ul style="list-style-type: none"> • Australian Window Standard for negative force strength pressure (AS4145.3-2001) • DW2 Australian Window Standard (AS4145.3-2001) |

Aeron® Window Control System

Window Sizes

- Maximum Window width Single Actuator - 900mm
- Maximum Window width Double Actuators* - 2400mm
- Minimum Window height - 300mm

Note: Actuator chain may need to be restricted, based on the sash size, as per the Aeron® window matrix.

* Must be in Sync connection.

Aeron® Actuator Features

- **Smart app control** – Manage all window actuators through the Yale Home App, with easy preset options like 'closed,' 'vent,' 'half,' and 'full' for quick adjustments.
- **Whisper-quiet performance** – Operates at just 55dB, even at full load, for minimal noise disruption.
- **Synchronized operation** – Actuators with 24V DC motors can work together in unison, allowing for smooth, synchronized window movement.
- **Ideal for wide windows** – Sync two actuators for larger window spans, ensuring efficient and balanced opening and closing.
- **Secure sealing** – Provides a strong 9kg closing force, keeping windows tightly sealed when shut.
- **Built to last** – Features a 304-grade stainless-steel chain, offering superior durability and corrosion resistance.
- **Adjustable chain length** – Easily set predefined window opening limits using a slide switch, tailoring ventilation to your needs.
- **Simplified installation** – A removable sash bracket and chain release key make installation hassle-free, even without a power connection.
- **Wireless setup** – Once powered, the actuators connect wirelessly via Zigbee Mesh technology—no additional wiring needed unless using a hard-wired wall switch.
- **Expanding Zigbee Mesh network** – Each actuator strengthens the network, reducing the need for multiple Yale Hub devices across the home.
- **Multiple control options** – Operate your windows with the Yale Home App, a handheld remote, or a wall switch—offering flexibility to match your lifestyle.
- **Versatile compatibility** – Suitable for awning and casement windows, and compatible with both timber and aluminium window frames.

Aeron® Smart Window Actuator Item Numbers

| Description | Part Number |
|------------------------------------|-----------------|
| Yale Aeron Wireless Actuator Black | YAR/WSWA/1/BLK |
| Yale Aeron Wireless Actuator White | YAR/WSWA/1/WH |
| Yale Aeron Wireless Actuator Spec | YAR/WSWA/1/SPEC |

Accessories

| Description | Part Number |
|--|------------------|
| Yale Connect Plus Hub 2 | YAR/SWAA/HUB/I-D |
| Yale Aeron System Zigbee Remote | YAR/SWAA/ZRT |
| Yale Aeron Actuator Zigbee Module | YAR/SWAA/ZMD |
| Yale Aeron Sync Loom | YAR/SWAA/SSL |
| Yale Aeron Standard 24VDC Power Supply | YAR/SWAA/SPS |
| Yale Aeron Rain Sensor and Adaptor | YAR/SWAA/SRS |

Spare Parts

| Description | Part Number |
|---------------------------------------|------------------|
| Yale Aeron Actuator Accessory Pack | YAR/SWAA/AP |
| Yale Aeron Actuator End Cap Black | YAR/SWAA/EC/BLK |
| Yale Aeron Actuator End Cap White | YAR/SWAA/EC/WH |
| Yale Aeron Actuator End Cap Spec | YAR/SWAA/EC/SPEC |
| Yale Aeron Pivot Bracket | YAR/SWAA/PVT |
| Yale Aeron Wiring 6pin Connector Plug | YAR/SWAA/W6CP |
| Yale Aeron Rain Sensor | YAR/SWAA/RS |
| Yale Aeron Rain Sensor | YAR/SWAA/RS |

Other Notes:

- 24V DC Power supply needs to be ordered separately; One power supply has enough power to operate 2 actuators (Sync setup) / windows.
- If two actuators are synchronized, they will only count as one device on the system. Wireless module must be removed from the Slave unit and slave unit must use power supply from master unit instead of having its own power supply
- A Yale Hub is required for wireless setup and connectivity, including use of Wireless Remote or smart Yale Home app. Yale Connect Plus Hub 2 is the primary Yale Hub offered with the Aeron® system, but alternative Yale Hub devices listed on the website as compatible with Aeron® may be used
- Maximum of 10 actuators can be connected to one wall switch. For optimal performance, AWG26 cable is recommended with 30m maximum run lengths.
- Maximum of 30 actuators can be connected to one remote
- Maximum 30 actuators and 4 remotes can be connected to Hub
- Hard-wired rain sensors will only operate the actuator directly wired to sensor

Aeron[®] System Overview

Product Operation Overview

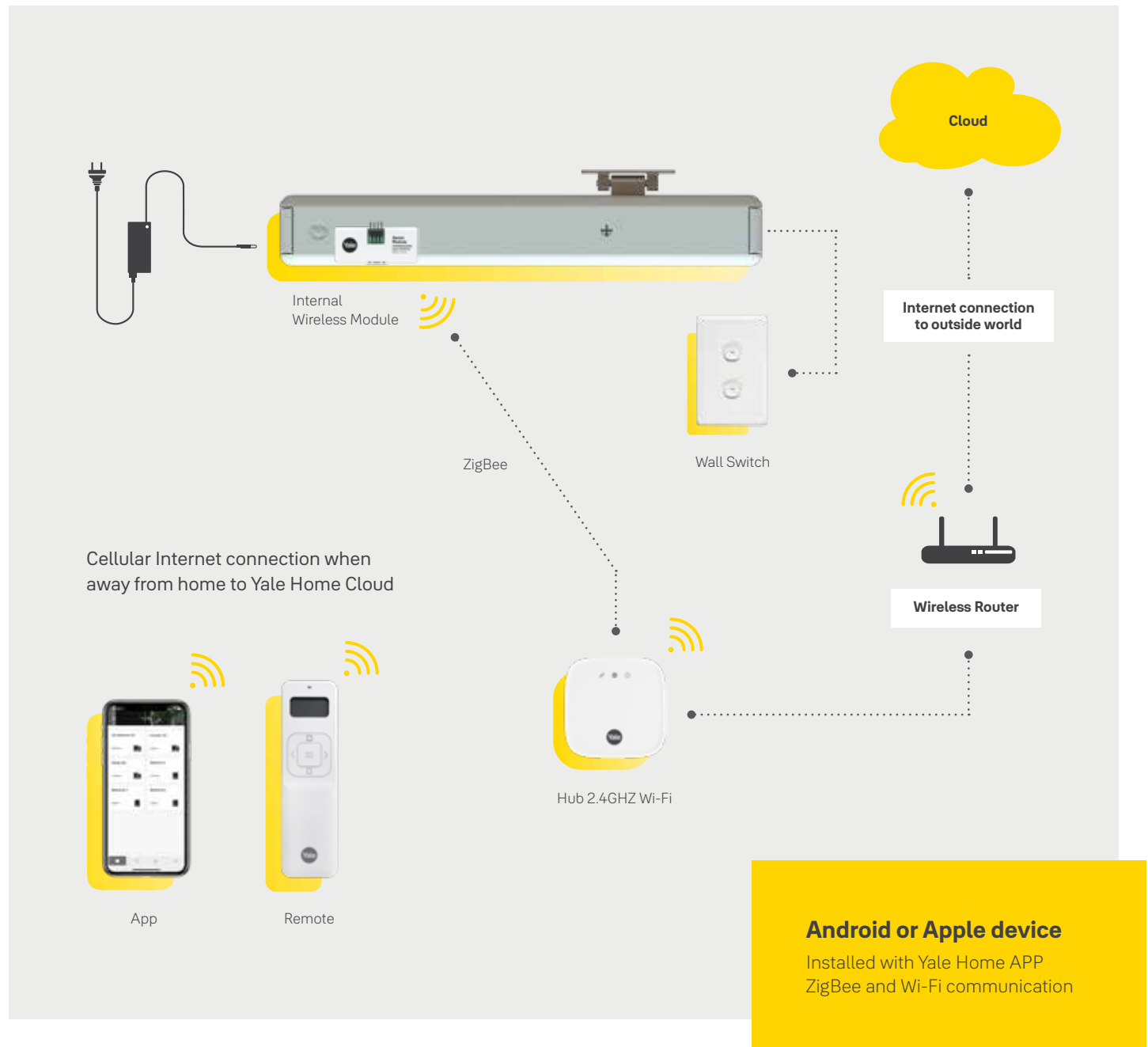

Aeron® System Wireless Remote



The Yale Aeron® Wireless Remote gives you effortless control over your Aeron® Smart Window Actuators, keeping your home connected and responsive. Designed to work with the Yale Hub via Zigbee mesh technology, it ensures smooth, reliable communication across your entire system.

With a sleek, modern design and user-friendly operation, the remote can manage up to 30 Aeron® Window Actuators, allowing you to open or close individual windows or groups with a simple press of a button.

Users have the option to instantly close all windows at once when leaving the building or locking up for the night if all actuators are grouped together. Aeron® remote allows you to easily decide which window or group of windows you would like to: Open or Close. For easy installation, Remote can be set into the Engineering mode to allow installer to test the Actuators without the need of internet. Scan QR code on back of the remote to get more information.

Applications

- Commercial Buildings
- Residential Buildings

Note: Indoor use only

Benefits

- Clear, day-and-night visibility – A 1.30-inch LCD interactive display keeps controls easy to read.
- Smart LED indicators – Different colours and patterns signal various operations at a glance (Refer to Remote Manual for detailed information).
- Battery-saving Auto Sleep Mode – Conserves power by switching the screen off when not in use.
- Always up to date – Supports over-the-air (OTA) updates for continuous improvements.
- Easy pairing & setup – Get started in seconds with a simple pairing process.
- Powerful window control – Manage up to 30 windows, grouped into four independent zones.
- One-touch operation – Instantly open or close all windows for convenience and security.
- Onsite testing made easy – Engineering mode allows installers to test actuators without an internet connection.
- Seamless app integration – Sync window grouping and positions from the Yale Home App.
- Instant error alerts – Built-in error message lights notify you of any issues.
- Reliable connectivity – The Zigbee mesh network extends range* and keeps all actuators connected.
- Pre-assigned grouping – All windows start in Group 1 (G1) and can be reassigned as needed.
- Low battery alerts – Stay ahead with notifications when it's time to recharge.
- Quick factory reset – Restore settings with just a few steps.
- Convenient wall cradle – Magnetic mount keeps your remote securely in place when not in use.

*Depend on the building layout and material



Aeron® System Wireless Remote

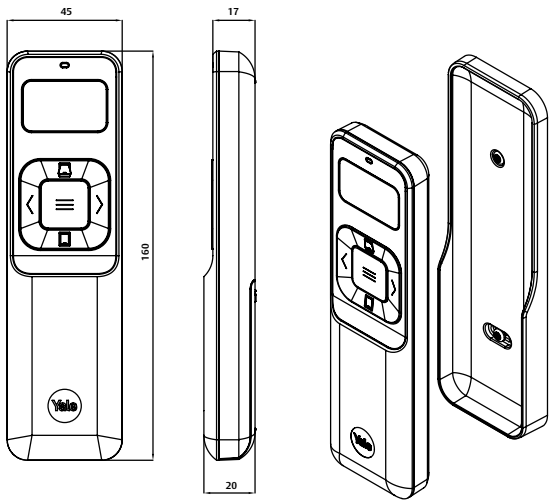

Hints and Tips

Low Battery Alert: When the battery drops below 20%, the LED flashes red slowly every 2 seconds as a reminder to replace the batteries

Sleep mode: To preserve battery life, the remote automatically enters sleep mode after 10 seconds of inactivity.

OTA (Over The Air Update):

- Keep your remote running smoothly with wireless software updates.
- During an update: The LED flashes green.
- Update successful: The LED illuminates green for 3 seconds.
- Update failed: The LED illuminates red for 3 seconds.
- OTA updates happen automatically when new software is available.

Factory Reset

On the back of the remote, beneath the battery cover, you'll find the factory reset button. To reset the remote:

1. Ensure the batteries are inserted.
2. Use a paperclip to press and hold the reset button for 5 seconds.
3. The LED on the front will flash green, confirming the reset is complete.
4. Once restarted, the remote will automatically enter pairing mode.

- **Actuator Grouping:** All actuators are assigned to Group 1 (G1) by default and cannot be removed. Groups 2–4 can be modified as needed.
- **Engineering Mode:** Press and hold "Confirm" and "Left Button" for 5 seconds until the LED turns solid green and the screen displays 9 and 99. To exit, remove the battery or reset the remote. Once actuators are connected to the Yale Hub/Yale Home App, Engineering Mode cannot be reactivated.

Technical Specifications

| | |
|-------------|--|
| Dimensions | 160H x 45W x 20D (dimensions are in mm) |
| Environment | Operational temperature range 0° to +60°C |
| Finishes | Snow White |
| Humidity | 90% @ 35°C |
| Materials | White Polycarbonate |
| Power | 2 x AA Batteries included |
| Compliance | <ul style="list-style-type: none">• Regulatory Compliance Mark (RCM) for AU & NZ• IP32 Rated• FCC Part 15b Compliance• FCC Part 15C Compliance (FCC ID: 2A9SQ-SWAAZRT)• ICES-003:2020 ISSUE 7• Industry Canada (IC ID: 29955-SWAAZMD) |

Aeron® System Wireless Remote

| Description | Part Number |
|---------------------------------|--------------|
| Yale Aeron System Zigbee Remote | YAR/SWAA/ZRT |

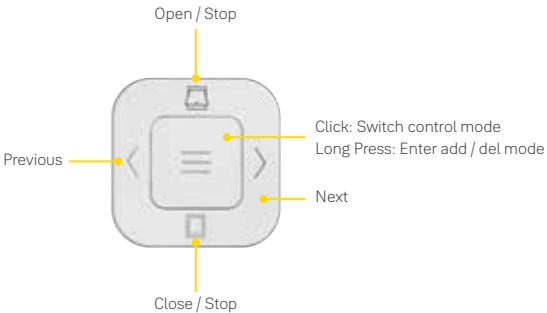
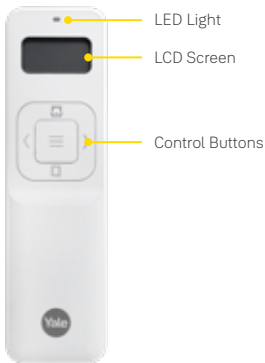

Yale Connect Plus Hub 2



The Yale Connect Plus Hub 2 gives you complete control of your Aeron® Smart Window System from anywhere in the world. Open, close, half-open, or vent your windows with ease, while also adding or removing devices, creating groups, and customising names for flexible, personalised control.

Supporting up to 30 Aeron® Actuators and 4 remotes, the Connect Plus Hub 2 ensures reliable connectivity with extended range.* Designed to work seamlessly with the Yale Home App, it also integrates effortlessly with other Yale Smart products, bringing smart home automation to the next level.

*Home size, layout and building material can impact performance. Medium and larger sized home may require additional devices for full coverage.

Applications

- Commercial Buildings
- Residential Buildings

Note: Indoor use only



Benefits

- Supports up to 30 Aeron® actuators and 4 remotes for seamless window control.
- Control from anywhere via the Yale Home App for ultimate convenience.
- Quick and easy setup with an app-driven process and QR code access.
- Always up to date with OTA updates for the latest features and improvements.
- Flexible placement – mount on a wall or place on a table. LED status indicators provide clear hub updates at a glance.
- Reliable connectivity with great range and 2.4GHz Wi-Fi compatibility (**not compatible with 5GHz networks**).
- Manual Wi-Fi pairing and reset options for added control.

Technical Specifications

| | |
|-----------------------|--|
| Communication | Wi-Fi 2.4GHz, ZigBee |
| Dimensions | 80W x 79H x 28D (dimensions are in mm) |
| Power | 5 VDC/1.0A power adaptor through USB-C power adaptor (included) |
| Plug Type | I plug |
| Operating Temperature | 0-60°C (For Hub), 0-40°C (For Power adaptor included) |
| Operating Humidity | 10-90% Non-condensing |
| Finish | Snow White |
| Compliance | <ul style="list-style-type: none">• Regulatory Compliance Mark (RCM) for AU & NZ• IP20 Rated• FCC Part 15C Compliance (FCC ID: 2A9SQ-SWAAHUB)• Industry Canada (IC ID: 29955-SWAAHUB) |

Yale® Connect Plus Hub 2

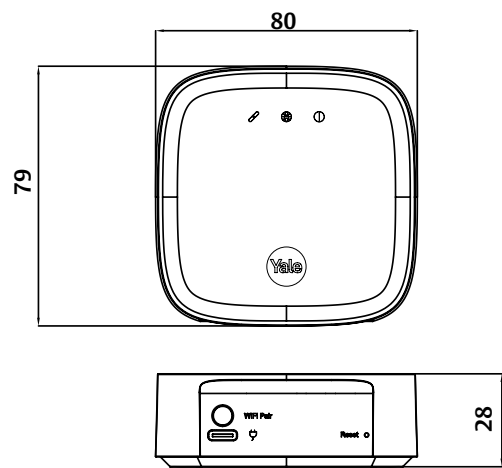

Hints & Tips for different LED lights operations:

- 1. Power LED
 - Solid LED = Hub is powered on
 - Slow flash LED = Hub is searching sub-devices
 - No LED = Hub is powered off
- 2. Wi-Fi Connection
 - Solid LED = Hub is connected to Wi-Fi router
 - Slow flash LED = Hub is in Wi-Fi connect mode
 - Fast flash LED = Firmware is being updated
 - No LED = Hub can't connect to Wi-Fi router
- 3. Server Connection
 - Solid LED = Hub is connected to Yale Home Server but there is no data being communicated at the time
 - Slow flash LED = Hub is communicating with Yale Home Server
 - No LED = Hub can't connect to Yale Home Server

Note: if all 3 LEDs blink consecutively then the Hub is currently undergoing a factory reset

Aeron® Connect Plus Hub

| Description | Part Number |
|-------------------------|-------------------|
| Yale Connect Plus Hub 2 | YAR/SWAA/HUB/-I-D |

Aeron® Wireless ZigBee Module



The Aeron® Wireless Zigbee Module brings wireless connectivity and smart functionality to the Aeron® Window Actuator. Acting as a bridge, it relays commands between the Yale Connect Plus Hub 2, the actuator, and other devices within the Zigbee mesh network, ensuring smooth, reliable communication.

This essential component upgrades the actuator from a hard-wired setup to a fully wireless system, unlocking the convenience of remote control via the Yale Home App. Simply connect through the Yale Connect Plus Hub 2, and you're ready to go.

Each Aeron® Actuator comes wireless-ready with the Aeron® Module pre-installed, but it can be removed or replaced if needed. For synchronised connections, the slave actuator must **NOT** have a module installed.

Benefits

- Operate window actuators wirelessly with Remote or the Yale Home App
- Zigbee mesh certified
- Easy to install/remove from the actuator
- Wireless Aeron® Module allows Aeron® actuator to register on the App hassle-free
- QR code scannable

| Technical Specifications | |
|--------------------------|---|
| Communication | ZigBee |
| Dimensions | 58W x 25H x 7.3D (dimensions are in mm) |
| Power | 5 VDC/1.0A (Powered by Aeron Host Actuator) |
| Operating Temperature | 0-40°C |
| Operating Humidity | 10-90% Non-condensing |
| Finish | Matt White |
| Compliance | <ul style="list-style-type: none">• Regulatory Compliance Mark (RCM) for AU & NZ• FCC Part 15b Compliance (Actuator with Zigbee module)• FCC Part 15C Compliance (Zigbee module FCC ID: 2A9SQ-SWAAZMD)• ICES-003:2020 ISSUE 7 (Actuator with Zigbee module)• Industry Canada (Zigbee module IC ID: 29955-SWAAZMD) |



Aeron® Wireless ZigBee Module



Hints and Tips: Module interchangeability

The Aeron® Module can be removed if needed, but it's also what gives each Aeron® Window Actuator its identity within the network.

This means you can move the module between different actuators, and its ID will stay the same in the Yale Home App or Aeron® Remote.

This is especially useful during setup, allowing you to:

- Configure all modules in one location before placing them in their final positions.
- Easily reassign actuators without resetting the entire system.

A simple way to streamline installation and customise your Aeron® smart window system to your needs!

Aeron® System Wireless Remote

| Description | Part Number |
|-----------------------------------|--------------|
| Yale Aeron Actuator Zigbee Module | YAR/SWAA/ZMD |

Yale Aeron® Rain Sensor



Let the Rain Sensor do the thinking for you.

Designed to work seamlessly with the Yale Aeron Window Control System, the Aeron Rain Sensor automatically closes your windows when it detects rain, so you don't have to.

How it works:

Automatic protection – Windows close instantly when rain is detected.

One-touch reopening – Use the Wall switch/Aeron wireless remote/Yale Home app to reopen windows once the rain stops.

Total control – The Rain Sensor controls all windows connected to the hard-wired system.

Stay dry, stay in control, without lifting a finger.

Applications

- Smart weather response – Automatically closes windows at the first sign of rain.
- Perfect for any space – Ideal for commercial and residential buildings.
- Built-in drying power – Integrated heating elements clear away dew and moisture.

Technical Specifications

| | |
|---|---|
| Dimensions | 60H x 50W x 16D (dimensions are in mm) |
| Materials | Body: Durable Acetal UV Stable |
| Bracket | Stainless Steel 304 |
| Voltage | 24-32 VDC |
| Current | Standby Current: 50mA Operating Current: 350mA |
| Environment Operational Temperature Range | 0° to +60°C |
| Humidity | 90% @ 35°C |
| Cabling Loom | 2m |

Yale Aeron® Rain Sensor

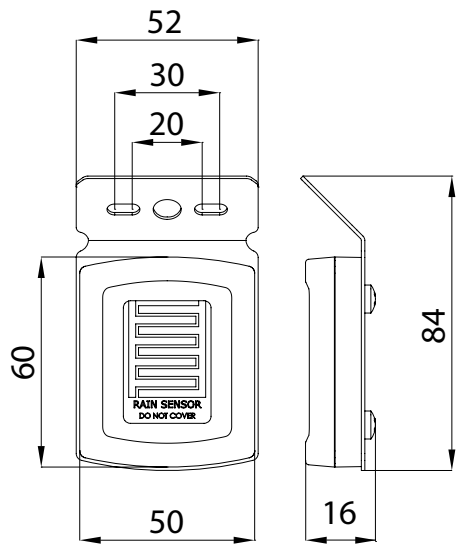

The Yale Aeron Rain Sensor shown above has an inbuilt bracket for easy installation on the exterior of the building.

The Rain Sensor is then wired to the Yale Rain Sensor Adaptor module, shown on the following page, which is then wired into the hard-wired circuit of Yale Aeron Window Actuators.

For further information, refer to the instruction manuals or the website.

Aeron Rain Sensor

| Description | Part Number |
|------------------------------------|--------------|
| Yale Aeron Rain Sensor | YAR/SWAA/RS |
| Yale Aeron Rain Sensor And Adaptor | YAR/SWAA/SRS |

Yale Aeron® Rain Sensor Adaptor



Easily link your Aeron® Window Actuators to the Aeron® Rain Sensor using the Aeron® Rain Sensor Adaptor. Enjoy seamless control and automated weather protection without hassle.

Simple and seamless, the Yale Aeron® Rain Sensor Adaptor connects to the Aeron Rain Sensor, allowing up to 10 windows to be controlled via a standard wall switch. Designed to sit discreetly behind the wall near the switch, it's ideal for managing windows connected to a wired circuit.

| Technical Specifications | |
|---|---|
| Dimensions | 130H x 82W x 20D (dimensions are in mm) |
| Materials Durable | ABS White Plastic |
| Voltage | 24-32 VDC |
| Standby Current | 50mA |
| Environment Operational Temperature Range | 0° to +60°C |
| Humidity | 90% @ 35°C |

Note: Aeron Rain Sensor and Adaptor only works with Hard-wired connection. It does not have wireless functionality.

Yale Aeron® Rain Sensor Adaptor

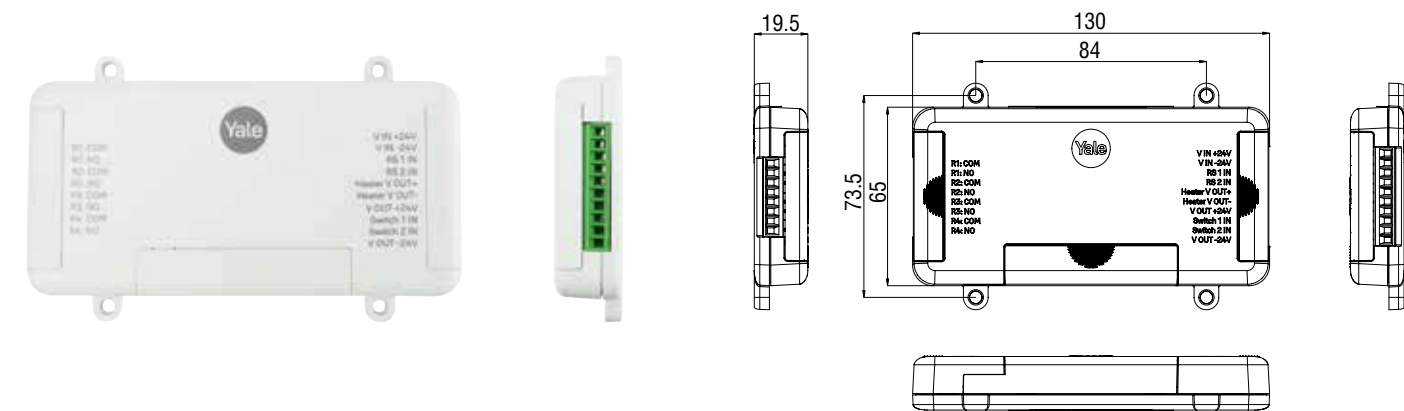

Aeron Rain Sensor Adaptor

| Description | Part Number |
|------------------------------------|--------------|
| Yale Aeron Rain Sensor Adaptor | YAR/SWAA/RSA |
| Yale Aeron Rain Sensor And Adaptor | YAR/SWAA/SRS |

Ordering Notes

One Rain Sensor and Adaptor is required for each hard-wired wall switch circuit.

Aeron® Accessories & Spare Parts

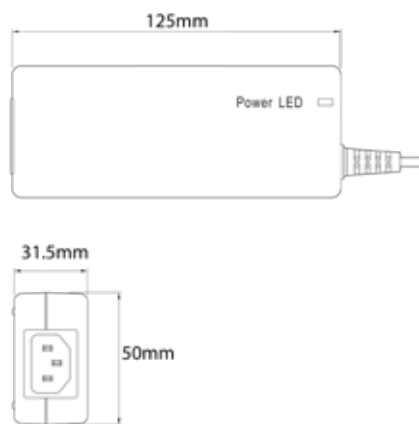

A full range of accessories and spare parts are available to support the installation and customisation of your Aeron® Smart Window System, ensuring seamless integration and long-term reliability.

YAR/SWAA/SPS: Yale Aeron® Standard 24VDC Power Supply

Each Aeron® Window Actuator requires a 24V DC power supply for operation. The Yale Aeron® Standard 24V DC Power Supply is designed to convert mains power to the required voltage, ensuring reliable performance.

For proper setup and installation, we recommend consulting a professional to determine the best solution for your system.

Note: Wiring must be completed by a licensed electrician. Please ensure that all wiring is completed by a professional to be compliant as governed by local building codes, regulations, and/or laws.

Features and Specifications

- 24V DC, 1.67A
- 600mA per Actuator. One power supply can power up to two Aeron® actuators
- For double Actuators (Synchronisation) setup, the same power supply must be used for both actuators



YAR/SWAA/SSL: Yale Aeron® Sync Loom

The 1.8m Synchronisation Loom Cable enables two Aeron® Window Actuators to work in perfect sync, with one as the master operator and the other as the slave actuator.

Ideal for windows over 900mm wide or heavier windows, this cable ensures smooth, coordinated movement, delivering the extra support needed for larger installations.

Aeron® Accessories & Spare Parts

Spares

The following products are all Spare Parts and all come complete with every Aeron® Window Actuator. They are listed as additional spares if required to be purchased separately.



YAR/SWAA/W6CP: Yale Aeron® Wiring 6pin Connector Plug

The 6-Pin Removable Connector Plug is designed for easy wiring installation with the Aeron® Actuator. Each pin is clearly numbered (1–6) to assist electricians, following the installation instructions and wiring diagrams. Available for separate purchase if needed.

Connector plug Pin Guide

- #1 V IN 24+ : Power from Transformer
- #2 IN 24- : Power from Transformer
- #3 OUT 24+ : Power output to switch (Common)
- #4 SW CLOSE : Switch Wire to Close
- #5 SW OPEN : Switch Wire to Open
- #6 V OUT 24- : Earth (Ground)

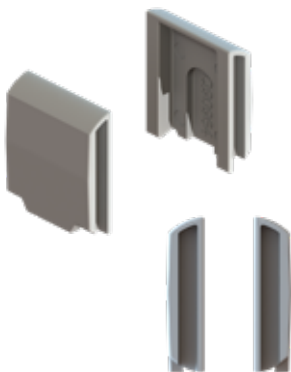

YAR/SWAA/EC/***: Yale Aeron® Actuator End Cap

Aeron® Actuator End Caps securely mount the actuator body onto the pivot bracket while providing a clean, finished look. Colour-matched to the actuator, they are made from durable cast zinc and come in pairs. A range of colours is available upon request.

| Description | Part Number |
|-----------------------------------|------------------|
| Yale Aeron Actuator End Cap Black | YAR/SWAA/EC/BLK |
| Yale Aeron Actuator End Cap White | YAR/SWAA/EC/WH |
| Yale Aeron Actuator End Cap SPEC | YAR/SWAA/EC/SPEC |

Aeron® Accessories & Spare Parts



YAR/SWAA/PVT: Yale Aeron® Pivot Bracket

The Yale Aeron® Pivot Bracket is a one-piece, stainless steel (304) bracket designed for easy installation and smooth operation. It allows the Aeron® Actuator to move slightly as it operates. Ensuring it follows the natural opening and closing arc of the window, helping to enhance durability and extend the system's lifespan.

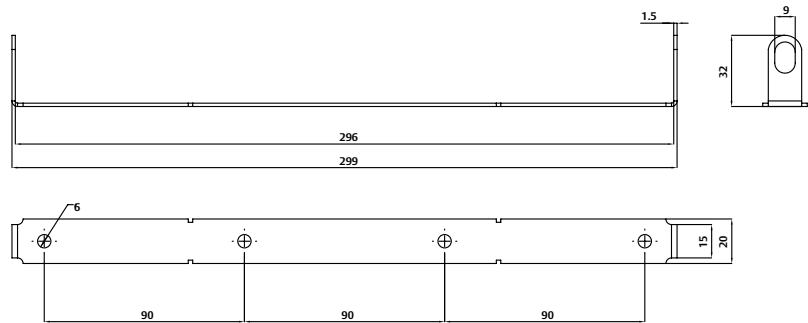

YAR/SWAA/AP: Yale Aeron® Actuator Accessory Pack

The Yale Aeron® Actuator Accessory kit include the following components:

- 1 x Chain release tool (Black)
- 1 x Clutch cover (Black)
- 1 x Aeron® cable entry cover (Black)
- 1 x Aeron® module cover (Black)
- 1 x 4g x 40 Stainless Steel Pozi #1 screw
- 4 x 8g x 1 Stainless Steel countersunk #2 screw
- 2 x 8g x 1/2 Stainless Steel pan #2 screw

Note: Aeron® covers are available in Black colour only.

ASSA ABLOY Australia Head Office

ASSA ABLOY Australia Pty Limited
235 Huntingdale Road, Oakleigh
Victoria, 3166 Australia

1300 LOCK UP (1300 562 587)
customerservice.au@assaabloy.com
assaabloy.com/au

yalehome.com/au

**Disclaimer**

Whilst every effort has been made to ensure that the information (including product images and drawings) contained in this brochure is accurate at the time of publication, ASSA ABLOY Australia Pty Limited ("ASSA ABLOY") recommends that you consult ASSA ABLOY or its agents prior to placing an order to ascertain current information on specific products, as ASSA ABLOY reserves the right to make changes without notice. ASSA ABLOY will not be liable for any injury, loss or damage whatsoever, arising from any errors or omissions in the information contained in the brochure or arising from the use or application of the information contained herein. © 2025 copyright by ASSA ABLOY All rights reserved

ASSA ABLOY Australia Pty Limited ABN 90 086 451 907 © 2025_02 | MC14793